

Cavity wall lintels - Medium duty

CC23 range

CC23 Lintels are designed for standard applications with high inner leaf loads; such as supporting roofs or concrete floors. The inner courses with a standard 215mm block.

Specification table for CC23 Lintels

Nominal cavity size (mm)	Nominal inner leaf (mm)	SPECIFY	Overall Height (mm)	Overall Width (mm)	Steel Gauge (mm)	Mass (kg/m)	Form Type	Ixx (cm ⁴)	Zxx (cm ³)
47-56	100-115	CC23-100/50/100	232	242	3.0	17.3	1	1661	125.8
	125-140	CC23-100/50/125	232	267	3.0	17.3	1	1599	115.1
	190-215	CC23-100/50/190	235	332	3.0	23.2	2	2103	129.0
57-71	100-115	CC23-100/60/100	232	252	3.0	17.3	1	1658	125.6
	125-140	CC23-100/60/125	232	277	3.0	17.3	1	1596	114.0
	190-215	CC23-100/60/190	235	342	3.0	23.5	2	2053	123.7
72-84	100-115	CC23-100/75/100	232	267	3.0	17.4	1	1663	126.0
	125-140	CC23-100/75/125	232	292	3.0	18.1	1	1759	131.3
	190-215	CC23-100/75/190	235	357	3.0	24.9	2	2383	148.0
85-96	100-115	CC23-100/90/100	232	280	3.0	17.4	1	1642	123.5
	125-140	CC23-100/90/125	232	305	3.0	17.4	1	1577	112.7
	190-215	CC23-100/90/190	235	370	3.0	25.3	2	2308	139.0
97-119	100-115	CC23-100/100/100	232	292	3.0	17.4	1	1625	122.2
	125-140	CC23-100/100/125	232	317	3.0	17.4	1	1559	110.5
	190-215	CC23-100/100/190	235	382	3.0	24.5	2	2238	136.5
120-139	100-115	CC23-100/120/100	232	315	3.0	18.2	3	1735	134.5
	125-140	CC23-100/120/125	232	340	3.0	18.3	3	1705	126.3
	190-215	CC23-100/120/190	235	405	3.0	25.9	4	2378	145.0
140-160	100-115	CC23-100/140/100	232	335	3.0	18.2	3	1709	132.5
	125-140	CC23-100/140/125	232	360	3.0	22.9	4	2130	139.2
	190-215	CC23-100/140/190	235	425	3.0	26.4	4	2369	142.7

NOTES: The actual lintel form varies over the range to maintain uniform load capacity, see below. Type CC23 lintels do not require a separate DPC for installation, and are supplied standard with separate stop ends*

STANDARD VARIATIONS OF ALL CC-TYPE LINTELS

FORM TYPE 1

Standard form for Cavity sizes up to 120mm and moderate inner leaf widths (No separate DPC required if over 150mm high).

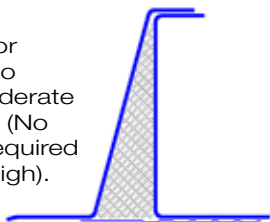

FORM TYPE 3

Features an extra bend in the outer web to maintain outer leaf support over wider cavities

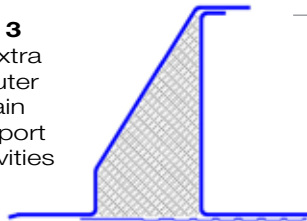

FORM TYPE 2

Form type 1 with an extra plate on the base to support a wide inner leaf and resist associated,

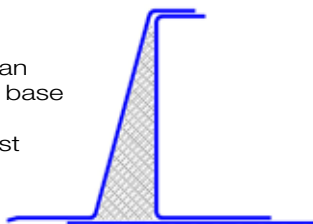

FORM TYPE 4

Form type 3 with an extra plate on the base to support a wide inner leaf in addition to the wide cavity,

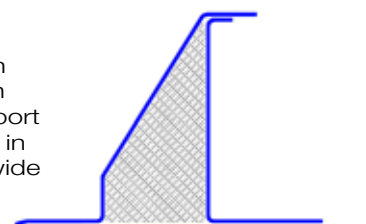

Need a stronger lintel? See CC24 >

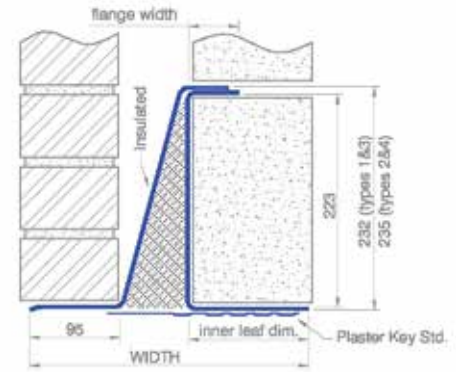

Allowable load for all CC23 Lintels*

Opening span	Lintel std length	Max total load (kN)*	Load Example (see pg 85)
1200	1500	59.7	masonry & concrete floor
1350	1650	59.7	
1500	1800	59.7	
1650	1950	59.7	
1800	2100	59.7	
1950	2250	59.7	masonry & tiled roof
2100	2400	59.7	
2250	2550	59.7	
2400	2700	59.7	
2550	2850	59.7	
2700	3000	58.0	masonry & timber floor
2850	3150	55.1	
3000	3300	52.5	
3150	3450	50.1	
3300	3600	47.9	
3450	3750	45.9	light blocks & light floor
3600	3900	44.1	
3750	4050	42.4	
3900	4200	40.8	
4050	4350	39.3	
4200	4500	37.7	900mm of masonry 30.8
4350	4650	35.1	
4500	4800	32.8	

Shorter & Intermediate lengths can be produced

Permissible Moment*: 20.7 kN.m
Permissible Point Load*: 18.2 kN

LOAD RATIO LIMITS* (OUTER : INNER)
65-100% Max load: 1:2 - 1:14 OR < 65% Max Load: 1:1 - 1:19

*See page 78 for loading & Installation guide

We can manufacture many variations of these lintels, supplied as standard in **LDX2101® Stainless Steel**.
Call 01206 79 2001 to inquire or visit www.stainless-lintels.co.uk